

134 TURNPIKE ROAD - FIRST FLOOR

SUITE 120 - 2,842 SF

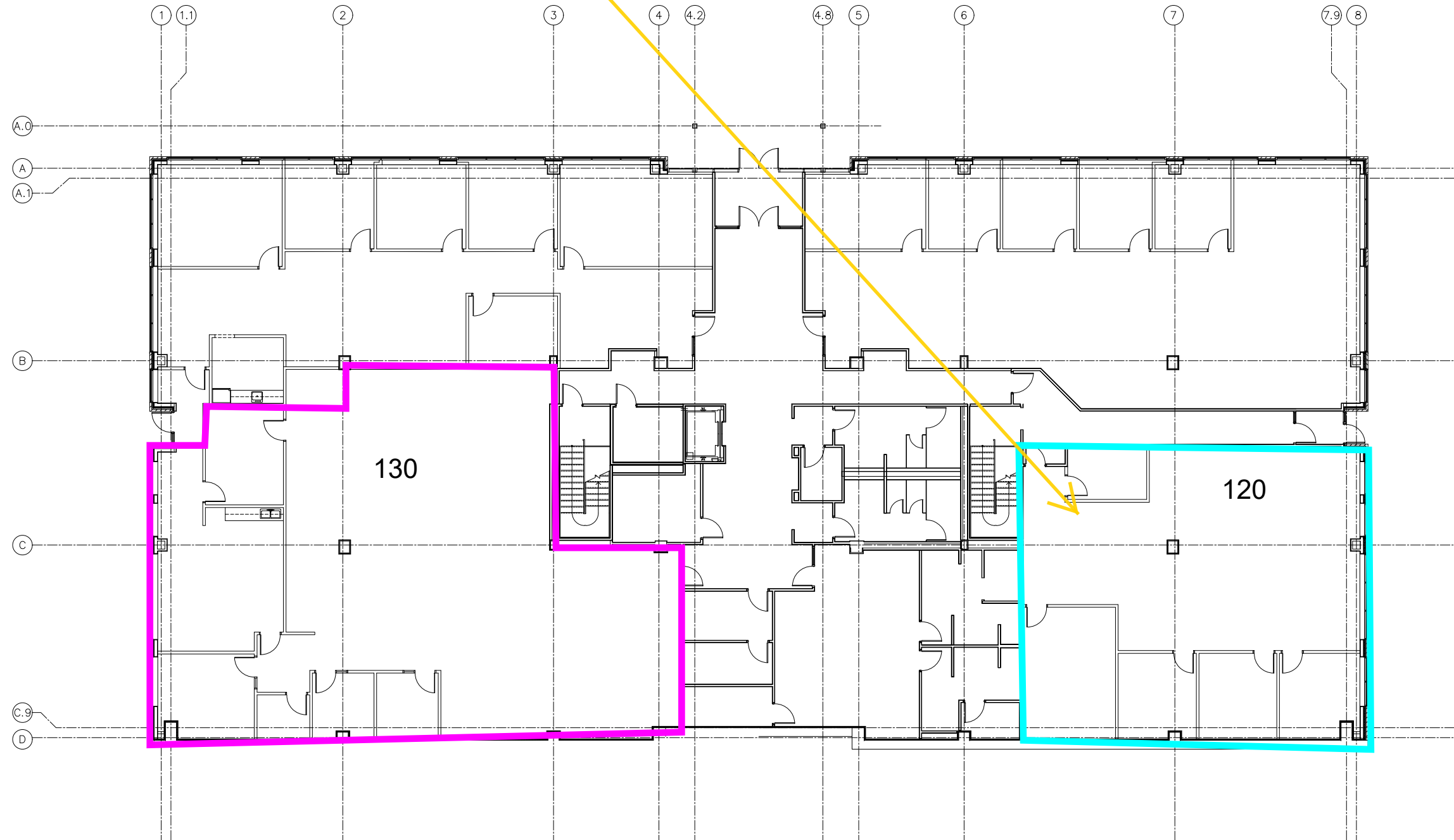

Notes:



Key Plan:

Architect's Stamp:

Project:

134 Turnpike
134 Turnpike Road
Southborough, MA 01772

Client:
Capital Group Properties
259 Turnpike Road
Southborough, MA 01772
Tel: (508) 357-8825

Project #: 14023

Scale: As Noted

Issue: _____ **Date:** _____

Revisions: _____ **Date:** _____

Drawing Title:
First Floor Existing Condition Plan

Sheet Number:
AEX.101



20 Chelmsford Street, Chelmsford, Ma. 01824
Tel: (978) 244.1100 Fax: (978) 244.1191
www.ahparchitects.com

EXISTING FIRST FLOOR PLAN 1
SCALE: 1/8" = 1'-0"